

4

3

2

1

RoHS
REACH
compliant

REVISION DATA

SYM	REV	DESCRIPTION	DATE	APPR.
	00	new part	30.03.17	MR

Electrical

Current rating:	0,5Amps/contact max.
Contact resistance:	$\leq 20\text{m}\Omega/\text{contact}$
Isolation resistance:	$\geq 1000\text{M}\Omega$ at $V=100\text{V}$
Withstanding Voltage:	300V AC/minute

Material

Contact:	Phosphor Bronze
Isolator:	High Temperature, Thermoplastic UL94V-0
Operating temperature:	Gold plated: -55°C to $+105^\circ\text{C}$ Tin plated: -40°C to $+105^\circ\text{C}$

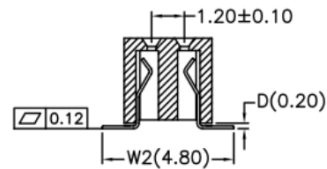
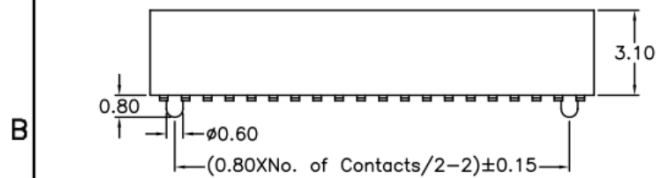
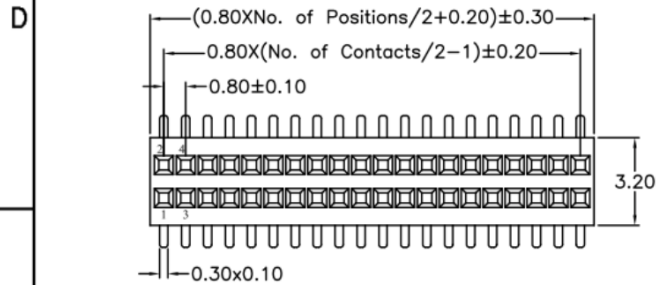

Common

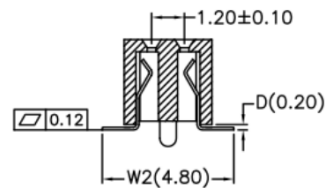

W/post

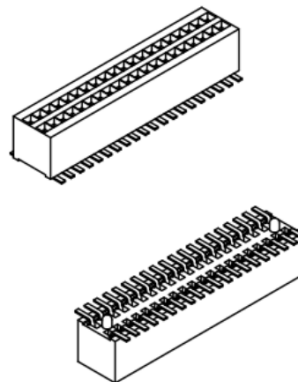
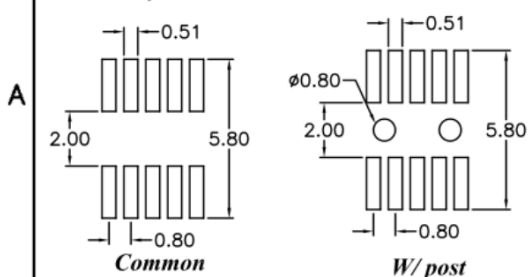
Recommended P.C.B Board
Layout

order information

B080150	xx	xx	xx	xx	xx
No. of Positions	Plating Option	Type	Packaging	Special Customer	
04~80	01= gold flash xx= on request	1= with peg 2= without peg xx= on request	F= tape&reel with cap E= tube&cap xx= on request		



BRCONNECTORS

Dual Row Female Header
Straight SMT Type

PROJECTON		general tolerances to DIN ISO 2768-1
DATE	30.03.2017	Customer Drawing- No.:
DRAWN	MR	Drawing- No.: 2160765
CHECKED	BR	
APPROVED	BR	UNIT: mm SCALE: SIZE: A4