

4

3

2

1



REVISION DATA				
SYM	REV	DESCRIPTION	DATE	APPR.
	00	new part	30.03.17	MR

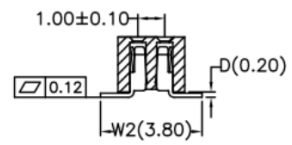
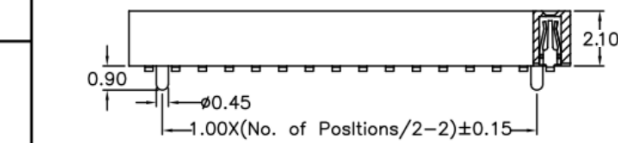
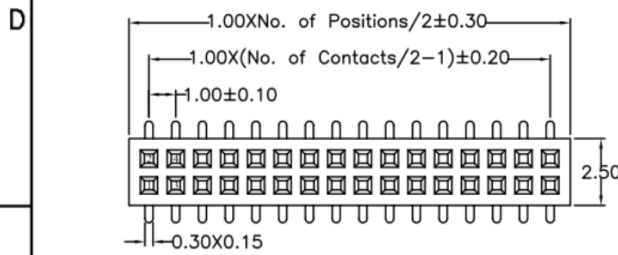

Common

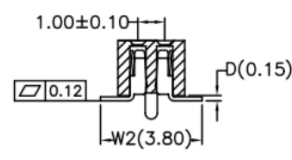

W/ Post

Electrical
Current rating: 0,75Amps/contact max.
Contact resistance: ≤20mΩ/contact
Isolation resistance: ≥1000MΩ at V=100V
Withstanding Voltage: 300V AC/minute

Material
Contact: Phosphor Bronze
Isolator: High Temperature, Thermoplastic UL94V-0

Operating temperature: Gold plated: -55°C to +105°C
 Tin plated: -40°C to +105°C

order information

B200150	XX	XX	XX	XX	XX	XX	XX
No. of Positions	Plating Option	Insulator Height	Type	Packaging	Dimension	Special Customer	
04~80	01= gold flash xx= on request	21= H= 2.10mm xx= on request	1= with peg 2= without peg xx= on request	E= tube&cap F= tape&reel with cap H= tape&reel with film xx= on request	D/ W2	xx= on request	

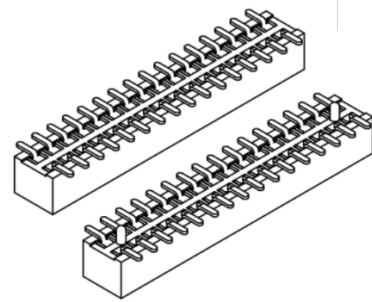
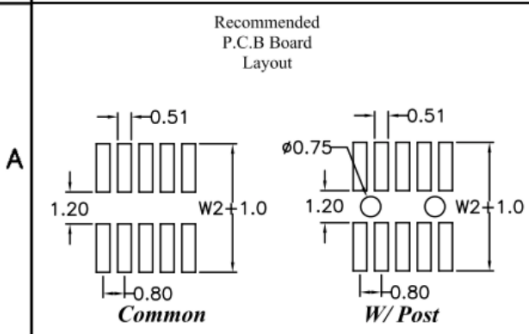

	Dual Row Female Header Straight SMT Type	
	PROJECTON	
	DATE	30.03.2017
	DRAWN	MR
CHECKED	BR	
APPROVED	BR	
Tolerance: X. ±0.50 .X ±0.35 .XX ±0.25 .XXX ±0.05 X* ±2°		Customer Drawing-No.: Drawing-No.: 2160773 UNIT: mm SCALE: SIZE: A4