

4

3

2

1



REVISION DATA				
SYM	REV	DESCRIPTION	DATE	APPR.
	00	new part	03.08.17	MR

Technical Specification

Current Rating: 3A AC, DC
 Voltage Rating: 500V AC,DC
 Temperature: -25°C to +85°C
high temperature: -40°C to +105°C
 Contact Resistance: 20mΩ
 Insulation Resistance: 500MΩ
 Withstanding Voltage: 1000V AC/minute
 Material Pin: Brass
 Material: Thermoplastic, UL94V-0

Circuit No.	Dimensions A	Dimensions B	Circuit No.	Dimensions A	Dimensions B
02P	2.50	7.50	09P	20.00	25.00
03P	5.00	10.00	10P	22.50	27.50
04P	7.50	12.50	11P	25.00	30.00
05P	10.00	15.00	12P	27.50	32.50
06P	12.50	17.50	13P	30.00	35.00
07P	15.00	20.00	14P	32.50	37.50
08P	17.50	22.50	15P	35.00	40.00

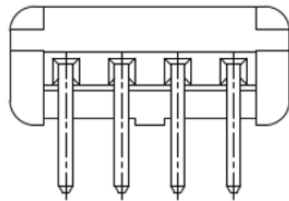
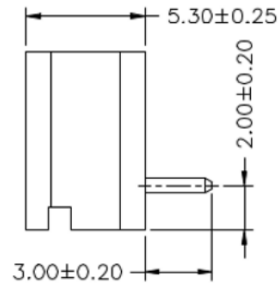
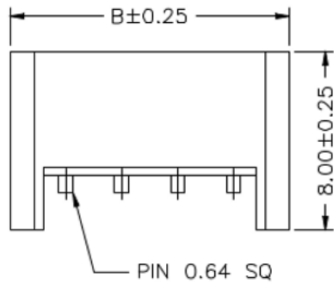
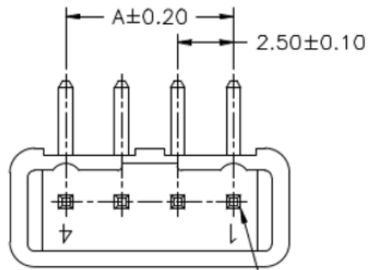

order information

C250406	xx	xx	xx	xx	xx
No. of Positions	Plating Option	Entry	Packaging	Special Customer	
02-15	01= gold flash	B2= side	A= bag	xx= on request	
xx= on request	100= tin		xx= on request		
			xx= on request		

D

C

B

A

D

C

B

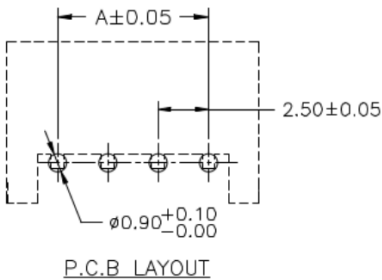
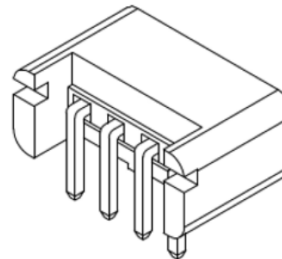

	PROJECTON		Single Row Wafer THT Type, Side Entry		
	DATE	03.08.2017	Customer Drawing-No.:		
	DRAWN	MR	Drawing-No.: 2161355		
	CHECKED	BR			
	APPROVED	BR	UNIT: mm	SCALE:	SIZE: A4