

4

3

2

1



REVISION DATA				
SYM	REV	DESCRIPTION	DATE	APPR.
	00	new part	03.08.17	MR

Technical Specification

Current Rating: 3A AC, DC
Voltage Rating: 250V AC,DC
Temperature: -25°C to +85°C
high temperature: -40°C to +105°C
Contact Resistance: 20mΩ
Insulation Resistance: 1000MΩ
Withstanding Voltage: 1500V AC/minute
Material Pin: Brass
Material: Thermoplastic, UL94V-0

Circuit No.	Dimensions			
	A	B	C	D
02P	2.54	8.89	---	5.33
03P	5.08	11.43	8.12	7.87
04P	7.62	13.97	10.66	10.41
05P	10.16	16.51	13.20	12.95
06P	12.70	19.05	15.74	15.49
07P	15.24	21.59	18.28	18.03
08P	17.78	24.13	20.82	20.57
09P	20.32	26.67	23.36	23.11
10P	22.86	29.21	25.90	25.65
11P	25.40	31.75	28.44	28.19
12P	27.94	34.29	30.98	30.73

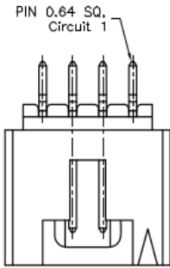

(TOP VIEW)

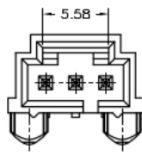
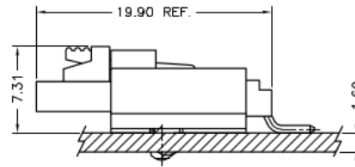
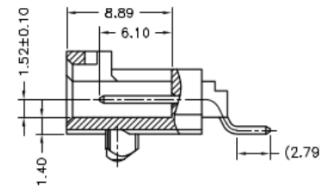
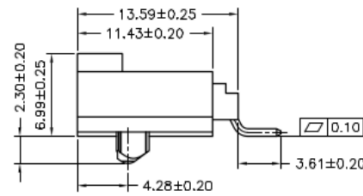
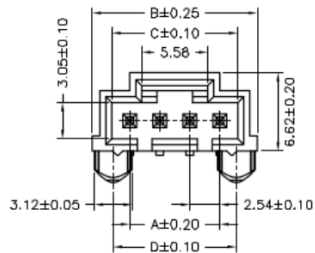

03P

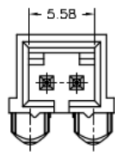

02P

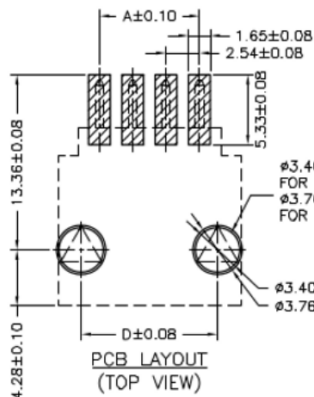

PCB LAYOUT (TOP VIEW)

∅3.40±0.05 THRU HOLE-2 PLCS. FOR PCB RETENTION
∅3.76±0.05 THRU HOLE-2 PLCS. FOR LOCATION ONLY

∅3.40±0.05
∅3.76±0.05

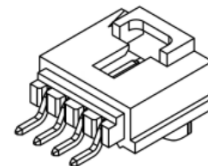

order information

C254401	xx	xx	xx	xx	xx	xx	xx
No. of Positions	Plating Option	Type	Entry	Peg	Packaging	Special Customer	
02-12	01= gold flash	A1= smt	B2= side	C2= with	D= tape&reel	xx= on request	
xx= on request	100= tin					xx= on request	
							xx= on request

	BRCONNECTORS		Single Row Wafer SMT Type, Side Entry			
	PROJECTON					
	DATE	03.08.2017	Customer Drawing-No.:			
	DRAWN	MR	Drawing-No.: 2161366			
CHECKED	BR					
APPROVED	BR					
Tolerance: .X ± 0.25 .XX ± 0.15 .XXX ± 0.05		UNIT:	SCALE:	SIZE:	A4	
		mm				