

4

3

2

1

RoHS REACH compliant

REVISION DATA				
SYM	REV	DESCRIPTION	DATE	APPR.
	00	new part	03.08.17	MR

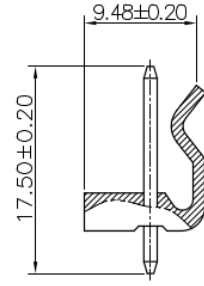
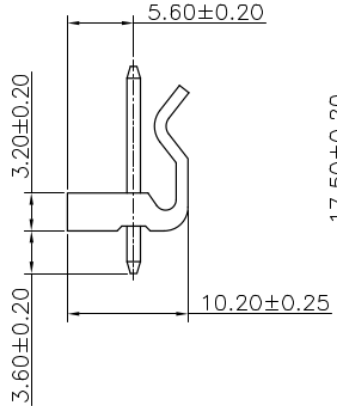
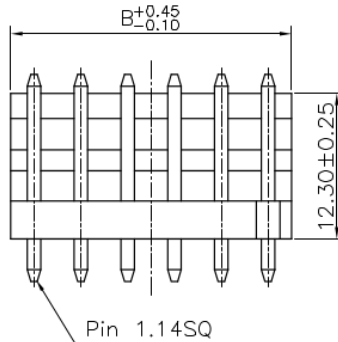
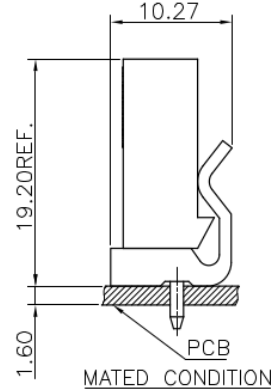
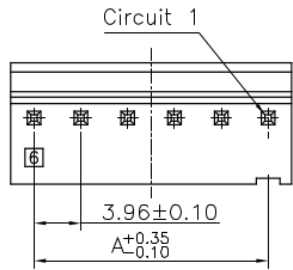

Technical Specification

Current Rating: 7A AC, DC
 Voltage Rating: 250V AC, DC
 Temperature: -25°C to +85°C
high temperature: -40°C to +105°C
 Contact Resistance: 10mΩ
 Insulation Resistance: 1000MΩ
 Withstanding Voltage: 1500V AC/minute
 Material Pin: Brass
 Material: Thermoplastic, UL94V-0

Circuit No.	Dimensions	
	A	B
02P	3.96	7.92
03P	7.92	11.88
04P	11.88	15.84
05P	15.84	19.80
06P	19.80	23.76
07P	23.76	27.72
08P	27.72	31.68
09P	31.68	35.64
10P	35.64	39.60
11P	39.60	43.56
12P	43.56	47.52

order information

c396403	xx	xx	xx	xx	xx
No. of Positions	Plating Option	Entry	Packaging	Special Customer	
02~12	01= gold flash	B1= top	A= bag	xx= on request	
xx= on request	100= tin		xx= on request		
			xx= on request		

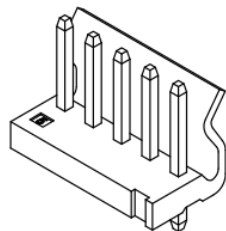
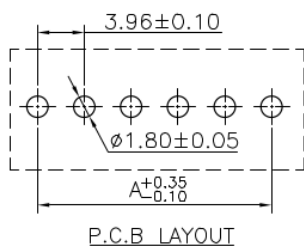

BRCONNECTORS

**Single Row Wafer
THT Type, Top Entry**

<p>Tolerance: .X ± 0.25 .XX ± 0.15 .XXX ± 0.05</p>	PROJECTON				
	DATE	03.08.2017	Customer Drawing- No.:		
	DRAWN	MR	Drawing- No.: 2161395		
	CHECKED	BR			
	APPROVED	BR	UNIT:	SCALE:	SIZE:
		mm		A4	