

4

3

2

1



REVISION DATA				
SYM	REV	DESCRIPTION	DATE	APPR.
	00	new part	03.08.17	MR

Technical Specification

Current Rating: 3A AC, DC
 Voltage Rating: 250V AC,DC
 Temperature: -25°C to +85°C
high temperature: on request
 Contact Resistance: 10mΩ
 Insulation Resistance: 1000MΩ
 Withstanding Voltage: 800V AC/minute
 Material: Thermoplastic, UL94V-0

Circuit No.	Dimensions	
	A	B
02P	2.50	6.00
03P	5.00	8.50
04P	7.50	11.00
05P	10.00	13.50
06P	12.50	16.00
07P	15.00	18.50
08P	17.50	21.00
09P	20.00	23.50
10P	22.50	26.00
11P	25.00	28.50
12P	27.50	31.00
13P	30.00	33.50
14P	32.50	36.00
15P	35.00	38.50
16P	37.50	41.00
17P	40.00	43.50
18P	42.50	46.00
19P	45.00	48.50
20P	47.50	51.00

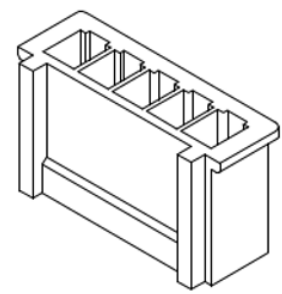
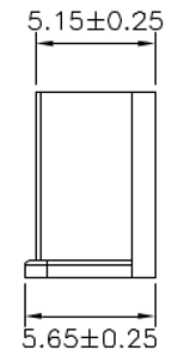
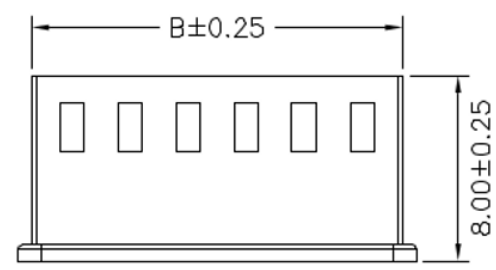
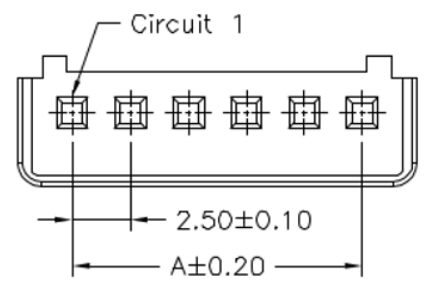

order information

D250404	xx	xx	xx
No. of Positions	Packaging	Special Customer	
02-20	A= bag	xx= on request	
xx= on request	xx= on request		

	Single Row Housing Straight Type		
	Tolerance:	PROJECTON	
	.X ± 0.25	DATE	03.08.2017
	.XX ± 0.15	DRAWN	MR
	.XXX ± 0.05	CHECKED	BR
	APPROVED	BR	
		UNIT: mm	SCALE:
			SIZE: A4

4

3

2

1



REVISION DATA				
SYM	REV	DESCRIPTION	DATE	APPR.
	00	new part	03.08.17	MR

Technical Specification

Current Rating: 3A AC,DC
Voltage Rating: 250V AC,DC
Temperature: -25°C to +85°C
high temperature: -40°C to +105°C
Contact Resistance: 10mΩ
Insulation Resistance: 1000MΩ
Withstanding Voltage: 800V AC/minute
Type: AWG #22 to #28, O.D.: 1.75mm (max)
Material: Brass

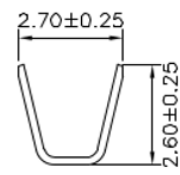
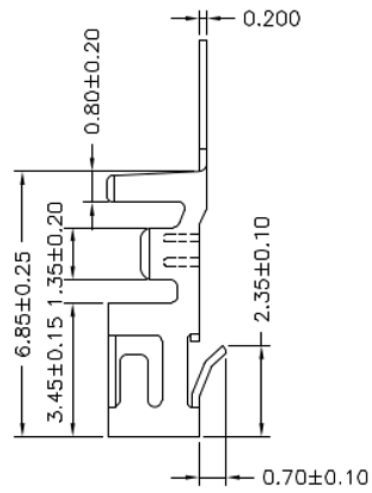
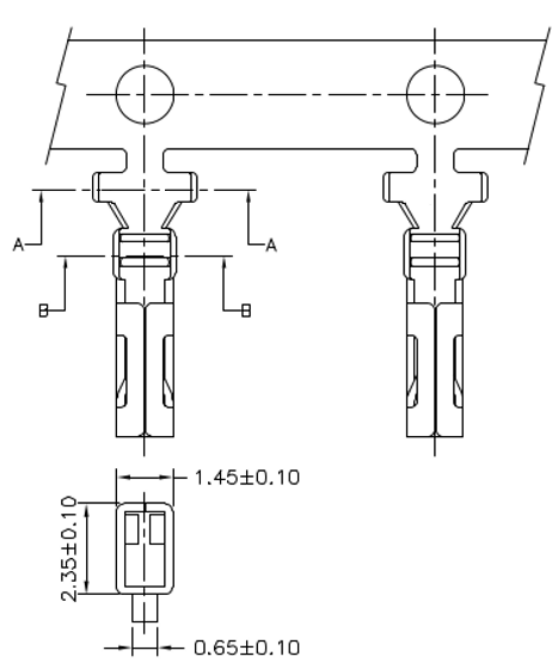

SEC:A-A



SEC:B-B

order information

E250404	xx	xx	xx
Plating Option	Packaging	Special Customer	
01= gold flash	D= tape&reel	xx= on request	
100= tin	xx= on request		
	xx= on request		

	Terminal Crimp		
	PROJECTON		
	DATE	03.08.2017	Customer Drawing- No.:
	DRAWN	MR	Drawing- No.: 2161345
	CHECKED	BR	
APPROVED	BR	UNIT: mm	SCALE: SIZE: A4